



Title Quick Tip: Seizure PDIs	Date 01/16/2019
CDE Number M-1901001	CDE Credit Hours .25 HRS

Paramount for Medical (5.1.1.27 - 7/12/2018)

File View Spec Logs Options Go to Language Tabs Version About ProQA

12: Convulsions / Seizures

:29 :24 12-D-2E

Entry	KQ	PDI/CEI	DLS	Summary
Post-Dispatch Instructions		Additional Information		
<p>a. I'm sending the paramedics (ambulance) to help you now. Stay on the line and I'll tell you exactly what to do next.</p> <p>c. If he is still seizing (or if he starts to seize again):</p> <ol style="list-style-type: none"> 1. Don't do CPR. 2. Don't hold him down or put anything into his mouth. 3. Move dangerous objects away from him. <p>d. (Still seizing) Tell me immediately when he stops seizing.</p> <p>f. (Effective breathing) Turn him gently on his side. As he wakes up, reassure him and tell him not to get up or walk around.</p>		<p>DLS Links</p> <ul style="list-style-type: none"> X-Card Not breathing (after KQs) INEFF BR & Not alert 		
Critical EMD Information				
* Stay on the line and check breathing often until the patient starts to wake up.				
b. (≥ 1 + D-1 or D-3) If there is a defibrillator (AED) available, send someone to get it now in case we need it later.				
e. (Not seizing & Not awake) Let's check his breathing (again). (Use the Breathing Verification Diagnostic.)				
* Stay on the line if the complaint is an impending seizure (aura)				

TREND ALERT! On the PDI "(Still Seizing) Tell me immediately when she stop seizing" call takers are stopping at that point and waiting for the patient to stop seizing. This is causing missed panels of instructions. Per Dr. Clawson, after this PDI is given, you simply move to the next one. The next PDI handles and reinforces what to do if the patient "wakes up" AND has effective breathing. On instructions where a "wait and see" is needed, there is a (pause) at the



end or (Wait) before those points. However, protocol 12 does not have any instructions with the pre-instruction qualifier of "wait". See the stroke diagnostic for an example shot with "(Wait)":

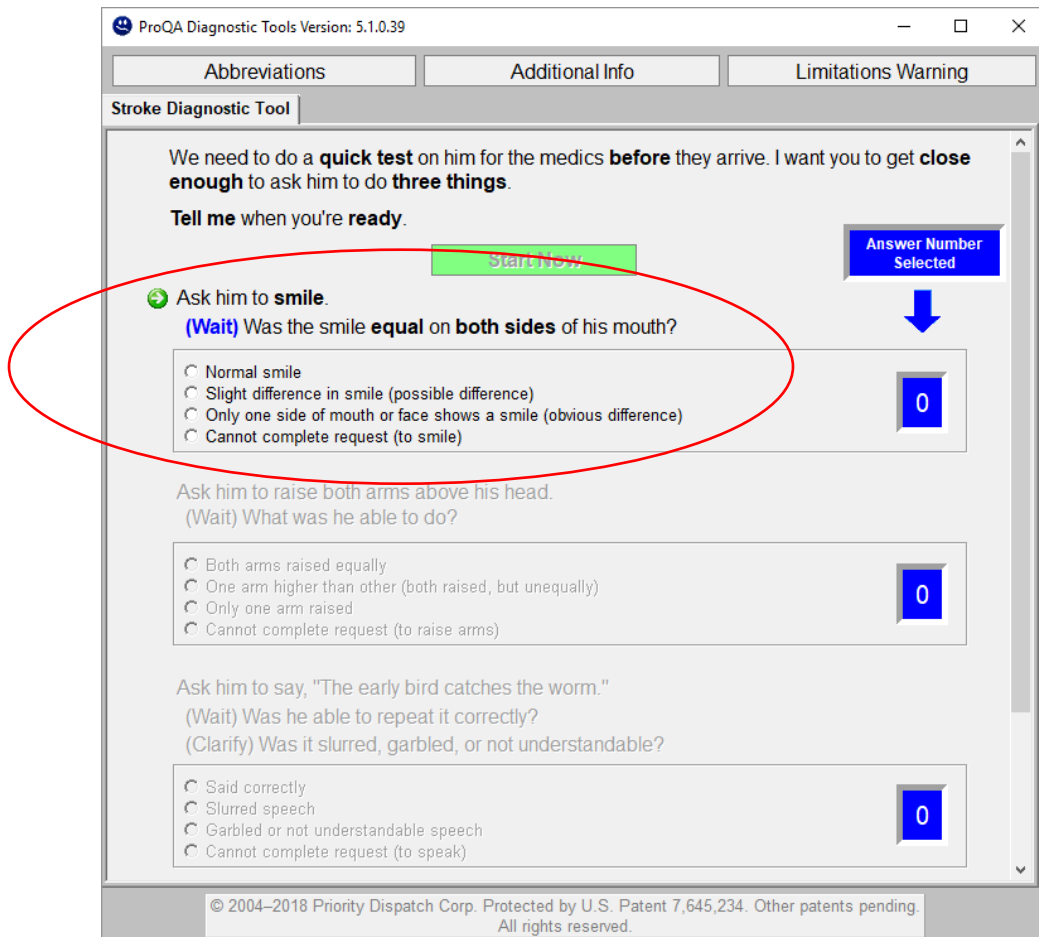

REMEMBER! You can give patient care instructions at ANY point of the call.

If the patient is still seizing, select "X-Card" then the "unstable" pathway is most appropriate. If the patient comes out of the seizure after you have passed the first panel of PDIs and ALREADY gave the "(Still Seizing) Tell me immediately when she stop seizing" instruction then you need to make sure to select your "target" icon located on top of ProQA. Please see the example of



panel X50 with the seizure PDIs. At this point, you would complete all possible and appropriate PDIs. Please see panel X50 below:

Paramount for Medical (5.1.1.27 - 7/12/2018)

File View Spec Logs Options Go Language Tabs Version About ProQA

1:37 :22 12: Convulsions / Seizures 12-D-2

Entry KQ PDI/CEI DLS Summary

X50 - Seizure PDIs

Relevant PDIs from Protocol 12

- c. If he is still **seizing** (or if he **starts** to seize again):
 1. **Don't do CPR.**
 2. **Don't hold him down** or **put anything into** his mouth.
 3. **Move dangerous objects** away from him.
- d. **(Still seizing)** Tell me **immediately** when he **stops** seizing.
- e. **(Not seizing & Not awake)** Let's **check** his **breathing** (again). **(Use the Breathing Verification Diagnostic.)**
- f. **(Effective breathing)** **Turn** him gently **on his side**. As he **wakes up**, reassure him and **tell** him **not** to get up or walk around.

Critical EMD Information

- * **Stay on the line** and **check breathing often** until the patient **starts to wake up**.
- * **Stay on the line** if the complaint is an **impending seizure (aura)**.

Main Additional Info

Go to KQs Go to PDIs

Last instruction - Close case

JNISKI O: NAE 35-year-old, Male, Conscious, Breathing. Code: 12-D-2:
MPDS 13.1.144 7/9/2018 C: NAE CONTINUOUS or MULTIPLE seizures



Title Quick Tip: Seizure PDIs	Date 01/16/2019
CDE Number M-1901001	CDE Credit Hours .25 HRS

I verify that I read and am familiar with the contents of this document.

Please return this to your agency's training coordinator for CDE credit. If you have any questions please contact us at 911training@elpasoteller911.org

X _____

Signature

DATE

X _____

Printed Name

X _____

Agency